

**BAD AXE LLC**

**DBA- BAD AXE**

**1002 N MEYER AVE  
SEABROOK TX 77586**

---





# **MISSION STATEMENT**

**To provide Seabrook, TX and surrounding areas with a unique and exciting entertainment opportunity while providing a family friendly and competitive environment that any age group 10+ can enjoy.**

A hand is shown holding a wooden-handled axe against a wooden target board. The target board features concentric circles and numbers (2, 3, 4) indicating different scoring zones. The axe is positioned vertically, with the head resting on the target. The background is a wooden wall.

# AXE THROWING

- **Family Fun Activity**
- **Date Night**
- **Guys/Girls Night Out**
- **Private Parties**
  - **Bachelor/Bachelorette  
/Birthday/Graduation**
- **Business Events**
- **Competition Leagues**
  - **Adult League**
  - **Youth League**

# **WORLD AXE THROWING LEAGUE (WATL)**

**WATL is the global governing body for the sport of Axe Throwing. WATL's mandate is to strengthen and support the sport of Axe Throwing by providing a source of standardized, global Axe Throwing competition. WATL's mission is to unify the sport of Axe Throwing through standard practices, common goals and industry-wide support.**

**-This Axe Throwing establishment will follow all WATL lane dimensions and safety standards along with all WATL approved equipment and target construction**



# SAFETY

**Lanes-** Each lane will be fenced all the way back to the throwing line. Lanes will be 6 feet wide and fenced all the way up to the ceiling. The throwing line will be placed at 12 feet and the safety line will be placed at 15 feet.

**Age Restrictions-** Minimum age to throw an axe will be 10 years old. Anyone who is not able to throw the axe to the target will not be able to participate.

**Waiver And Clothing-** All players/participants and spectators must read and sign the waiver before being allowed to throw. Closed-toed shoes are also required.

**Stay In Safety Areas-** There is only one person in a lane at any time. Do not enter a lane until it is completely cleared. When entering a lane, step directly into your lane, do not wander into another players area. If you are not throwing, you must remain behind the yellow safety line.

**One Axe At A time-** Only one axe is thrown at a time in each lane. Whether it sticks or not, retrieve the axe that is thrown before starting another turn.

**No Axes Outside The Fence-** Do not remove an axe from the throwing area. All axes must remain in the fenced in area at all times.

**Don't Touch The Fence-** Do not touch or grab the fence, either in the spectator area, or especially when picking up an axe off the ground.

**Don't Hand Off An Axe-** Do not hand another player an axe. When done throwing, replace your axe in the wood box and exit the area. The next player can then select their own axe when entering.

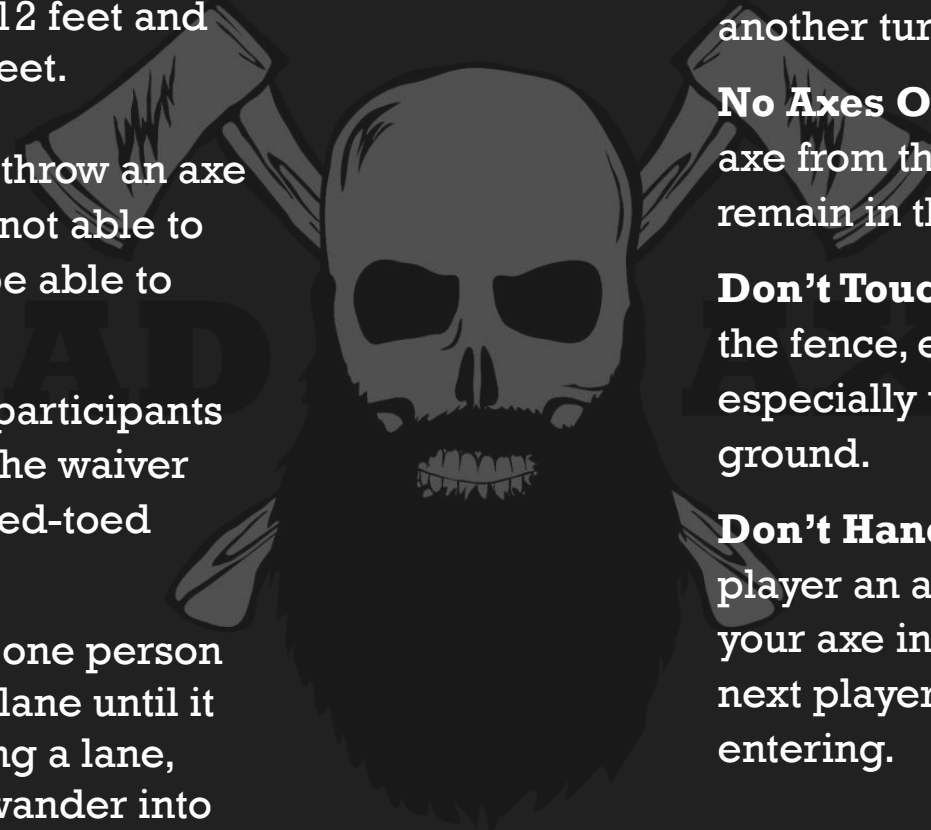

BAD AXE LLC  
1002 N. MEYER AVE STE. A  
SEABROOK TX 77586

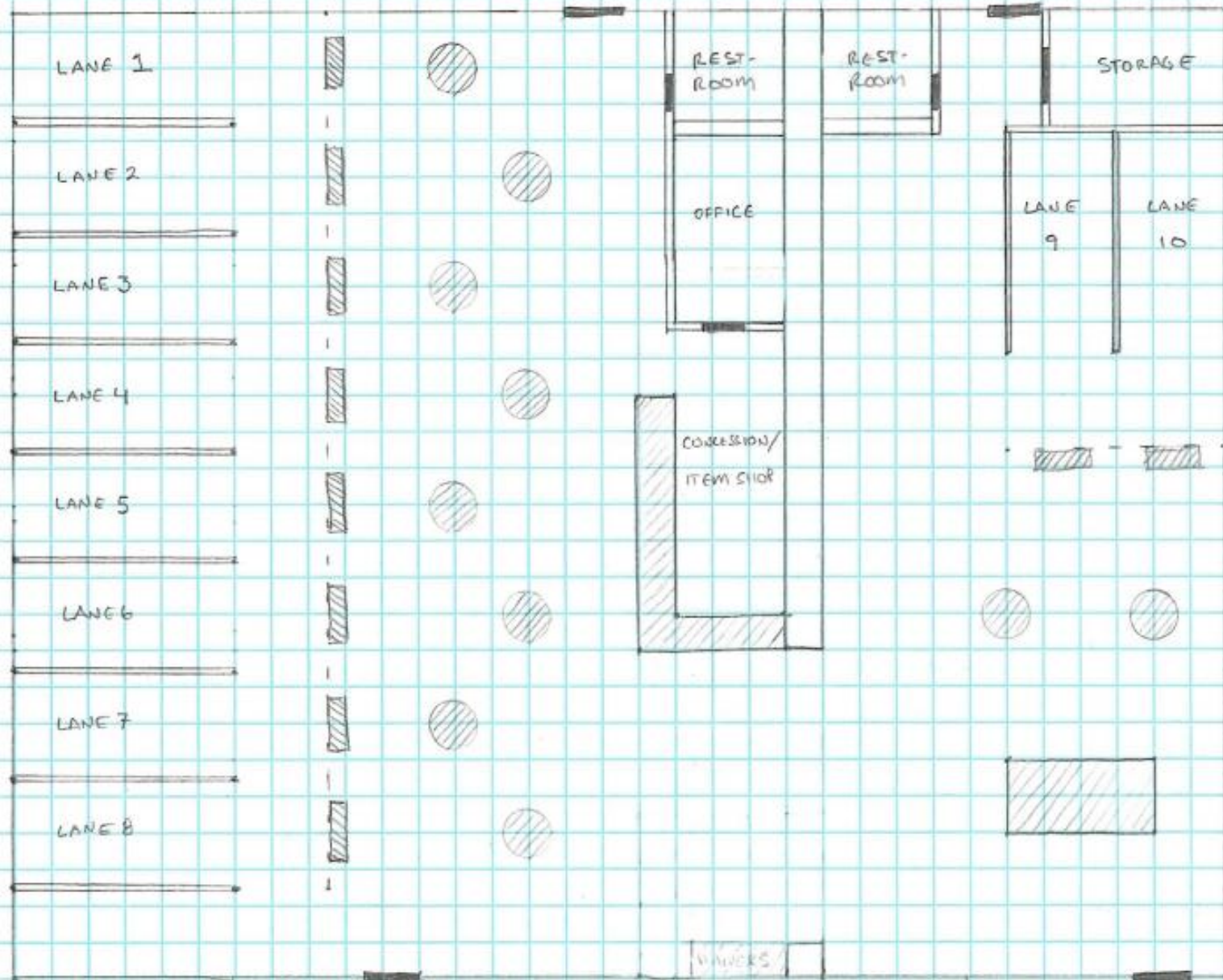

- **10 Throwing lanes**
  - **8 lanes main room**
  - **2 lanes private room**
- **Scoring table with 2 chairs per lane**
- **Cocktail table with 4 chairs per lane**
- **2 unisex restrooms, one on main side and one on private event side**
- **Private event room**
  - **2 dedicated lanes**
  - **8ft table with 10 chairs for events**

# CONCESSION/ITEM SHOP & DRINK POLICY

## Concessions/ Item shop

- **Packaged foods sold (common vending machine items)**
- **Sodas, water, teas, energy drinks**
- **BAD AXE apparel i.e. shirts, hats**
- **BAD AXE keep sakes i.e. koozies, key chains**
- **Personal throwing axes**

## Drink Policy

- **Ages 21+ who want to drink socially may bring their own alcoholic beverages**
- **Anyone intoxicated or under the influence will not be allowed to throw axes**

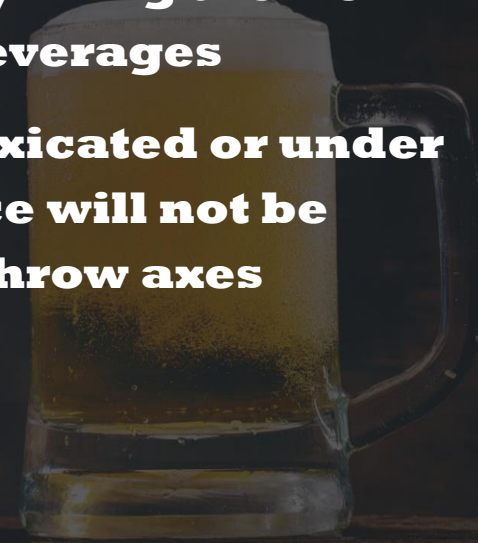

# INSURANCE



\$1M Per  
Occurrence / \$2M  
Aggregate General  
Liability



\$40K Business  
Personal Property

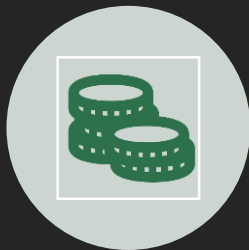

\$100K Business  
Income Loss



\$100K Tenant's  
Improvements /  
Betterments