

REQUIRED INTERSECTION SITE DISTANCE	
DESIGN SPEED (MPH)	SITE DISTANCE (FT)*
30	200
35	250
40	305
45	360
50	425
55	495

*NOTE:
 1. INTERSECTION SITE DISTANCES ARE BASED ON AMERICAN ASSOCIATION OF STATE HIGHWAY AND TRANSPORTATION OFFICIALS (AASHTO) CRITERIA FOR INTERSECTION SITE DISTANCE.

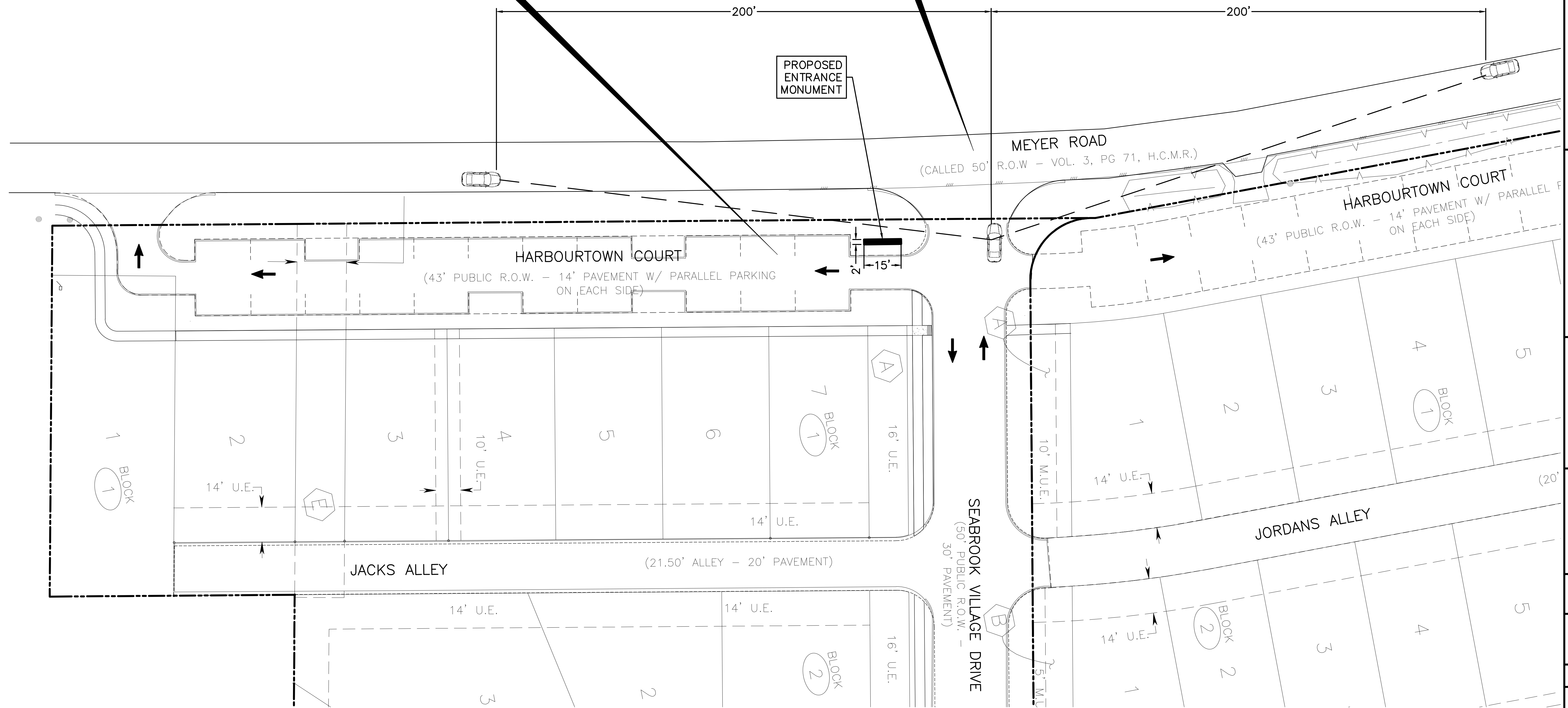

**OLD SEABROOK VILLAGE
 SECTION A
 MEYER ROAD - SEABROOK, TEXAS**

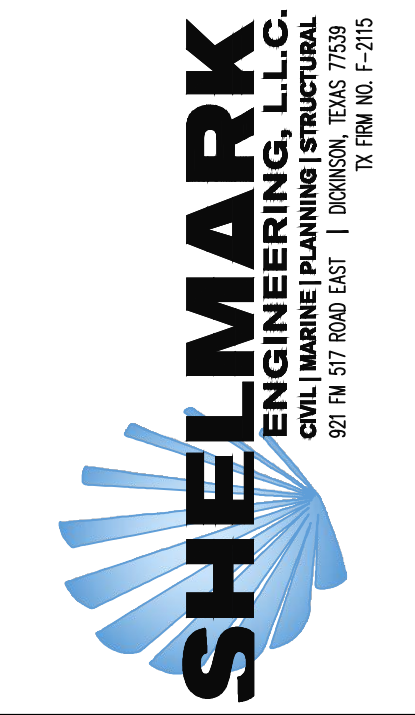

ISSUED FOR	11/23/21
REVIEW	

DWG NAME:	ENTRANCE MONUMENT SIGN EXHIBIT
-----------	--------------------------------

DWG NO:	C-1
SCALE:	1" = 20'
BY:	CLI
JOB NO:	17-353
REV:	A

SHELMARK ENGINEERING, L.L.C. PROJECTS: 17-353, 17-354, 17-355, 17-356, 17-357, 17-358, 17-359, 17-360, 17-361, 17-362, 17-363, 17-364, 17-365, 17-366, 17-367, 17-368, 17-369, 17-370, 17-371, 17-372, 17-373, 17-374, 17-375, 17-376, 17-377, 17-378, 17-379, 17-380, 17-381, 17-382, 17-383, 17-384, 17-385, 17-386, 17-387, 17-388, 17-389, 17-390, 17-391, 17-392, 17-393, 17-394, 17-395, 17-396, 17-397, 17-398, 17-399, 17-400, 17-401, 17-402, 17-403, 17-404, 17-405, 17-406, 17-407, 17-408, 17-409, 17-410, 17-411, 17-412, 17-413, 17-414, 17-415, 17-416, 17-417, 17-418, 17-419, 17-420, 17-421, 17-422, 17-423, 17-424, 17-425, 17-426, 17-427, 17-428, 17-429, 17-430, 17-431, 17-432, 17-433, 17-434, 17-435, 17-436, 17-437, 17-438, 17-439, 17-440, 17-441, 17-442, 17-443, 17-444, 17-445, 17-446, 17-447, 17-448, 17-449, 17-450, 17-451, 17-452, 17-453, 17-454, 17-455, 17-456, 17-457, 17-458, 17-459, 17-460, 17-461, 17-462, 17-463, 17-464, 17-465, 17-466, 17-467, 17-468, 17-469, 17-470, 17-471, 17-472, 17-473, 17-474, 17-475, 17-476, 17-477, 17-478, 17-479, 17-480, 17-481, 17-482, 17-483, 17-484, 17-485, 17-486, 17-487, 17-488, 17-489, 17-490, 17-491, 17-492, 17-493, 17-494, 17-495, 17-496, 17-497, 17-498, 17-499, 17-500, 17-501, 17-502, 17-503, 17-504, 17-505, 17-506, 17-507, 17-508, 17-509, 17-510, 17-511, 17-512, 17-513, 17-514, 17-515, 17-516, 17-517, 17-518, 17-519, 17-520, 17-521, 17-522, 17-523, 17-524, 17-525, 17-526, 17-527, 17-528, 17-529, 17-530, 17-531, 17-532, 17-533, 17-534, 17-535, 17-536, 17-537, 17-538, 17-539, 17-540, 17-541, 17-542, 17-543, 17-544, 17-545, 17-546, 17-547, 17-548, 17-549, 17-550, 17-551, 17-552, 17-553, 17-554, 17-555, 17-556, 17-557, 17-558, 17-559, 17-560, 17-561, 17-562, 17-563, 17-564, 17-565, 17-566, 17-567, 17-568, 17-569, 17-570, 17-571, 17-572, 17-573, 17-574, 17-575, 17-576, 17-577, 17-578, 17-579, 17-580, 17-581, 17-582, 17-583, 17-584, 17-585, 17-586, 17-587, 17-588, 17-589, 17-590, 17-591, 17-592, 17-593, 17-594, 17-595, 17-596, 17-597, 17-598, 17-599, 17-600, 17-601, 17-602, 17-603, 17-604, 17-605, 17-606, 17-607, 17-608, 17-609, 17-610, 17-611, 17-612, 17-613, 17-614, 17-615, 17-616, 17-617, 17-618, 17-619, 17-620, 17-621, 17-622, 17-623, 17-624, 17-625, 17-626, 17-627, 17-628, 17-629, 17-630, 17-631, 17-632, 17-633, 17-634, 17-635, 17-636, 17-637, 17-638, 17-639, 17-640, 17-641, 17-642, 17-643, 17-644, 17-645, 17-646, 17-647, 17-648, 17-649, 17-650, 17-651, 17-652, 17-653, 17-654, 17-655, 17-656, 17-657, 17-658, 17-659, 17-660, 17-661, 17-662, 17-663, 17-664, 17-665, 17-666, 17-667, 17-668, 17-669, 17-670, 17-671, 17-672, 17-673, 17-674, 17-675, 17-676, 17-677, 17-678, 17-679, 17-680, 17-681, 17-682, 17-683, 17-684, 17-685, 17-686, 17-687, 17-688, 17-689, 17-690, 17-691, 17-692, 17-693, 17-694, 17-695, 17-696, 17-697, 17-698, 17-699, 17-700, 17-701, 17-702, 17-703, 17-704, 17-705, 17-706, 17-707, 17-708, 17-709, 17-710, 17-711, 17-712, 17-713, 17-714, 17-715, 17-716, 17-717, 17-718, 17-719, 17-720, 17-721, 17-722, 17-723, 17-724, 17-725, 17-726, 17-727, 17-728, 17-729, 17-730, 17-731, 17-732, 17-733, 17-734, 17-735, 17-736, 17-737, 17-738, 17-739, 17-740, 17-741, 17-742, 17-743, 17-744, 17-745, 17-746, 17-747, 17-748, 17-749, 17-750, 17-751, 17-752, 17-753, 17-754, 17-755, 17-756, 17-757, 17-758, 17-759, 17-760, 17-761, 17-762, 17-763, 17-764, 17-765, 17-766, 17-767, 17-768, 17-769, 17-770, 17-771, 17-772, 17-773, 17-774, 17-775, 17-776, 17-777, 17-778, 17-779, 17-780, 17-781, 17-782, 17-783, 17-784, 17-785, 17-786, 17-787, 17-788, 17-789, 17-790, 17-791, 17-792, 17-793, 17-794, 17-795, 17-796, 17-797, 17-798, 17-799, 17-800, 17-801, 17-802, 17-803, 17-804, 17-805, 17-806, 17-807, 17-808, 17-809, 17-810, 17-811, 17-812, 17-813, 17-814, 17-815, 17-816, 17-817, 17-818, 17-819, 17-820, 17-821, 17-822, 17-823, 17-824, 17-825, 17-826, 17-827, 17-828, 17-829, 17-830, 17-831, 17-832, 17-833, 17-834, 17-835, 17-836, 17-837, 17-838, 17-839, 17-840, 17-841, 17-842, 17-843, 17-844, 17-845, 17-846, 17-847, 17-848, 17-849, 17-850, 17-851, 17-852, 17-853, 17-854, 17-855, 17-856, 17-857, 17-858, 17-859, 17-860, 17-861, 17-862, 17-863, 17-864, 17-865, 17-866, 17-867, 17-868, 17-869, 17-870, 17-871, 17-872, 17-873, 17-874, 17-875, 17-876, 17-877, 17-878, 17-879, 17-880, 17-881, 17-882, 17-883, 17-884, 17-885, 17-886, 17-887, 17-888, 17-889, 17-890, 17-891, 17-892, 17-893, 17-894, 17-895, 17-896, 17-897, 17-898, 17-899, 17-900, 17-901, 17-902, 17-903, 17-904, 17-905, 17-906, 17-907, 17-908, 17-909, 17-910, 17-911, 17-912, 17-913, 17-914, 17-915, 17-916, 17-917, 17-918, 17-919, 17-920, 17-921, 17-922, 17-923, 17-924, 17-925, 17-926, 17-927, 17-928, 17-929, 17-930, 17-931, 17-932, 17-933, 17-934, 17-935, 17-936, 17-937, 17-938, 17-939, 17-940, 17-941, 17-942, 17-943, 17-944, 17-945, 17-946, 17-947, 17-948, 17-949, 17-950, 17-951, 17-952, 17-953, 17-954, 17-955, 17-956, 17-957, 17-958, 17-959, 17-960, 17-961, 17-962, 17-963, 17-964, 17-965, 17-966, 17-967, 17-968, 17-969, 17-970, 17-971, 17-972, 17-973, 17-974, 17-975, 17-976, 17-977, 17-978, 17-979, 17-980, 17-981, 17-982, 17-983, 17-984, 17-985, 17-986, 17-987, 17-988, 17-989, 17-990, 17-991, 17-992, 17-993, 17-994, 17-995, 17-996, 17-997, 17-998, 17-999, 18000.